

BILL OF MATERIAL

SEQ #	SEQ	SHIP MARK	QUAN TOTAL	DESCRIPTION	LENGTH FT IN	STEEL GRADE	REMARKS	P.O. Ref #	TOTAL WEIGHT
1	153A-2		ONE BEAM					1-47	2853
			1	W24x55	41	54	A992		2281
			1	L6x3 1/2 x 5/16	40	54	A36		397
			1	L6x3 1/2 x 5/16	40	54	A36		397
			2	L6x3 1/2 x 5/16	40	54	A36		794
			11	1 1/2 x 1/2 A307	0	1 1/2	A307		
1	153B-1		ONE BEAM					1-38	2815
			1	W24x68	41	4 3/4	A992		2815

Total weight : 6684

SPECIAL MOMENT BEAM WEB PREP FS

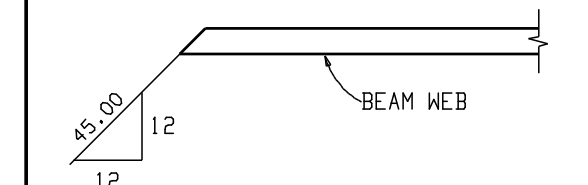

REV	DATE	DESCRIPTION	SHOP	REV	DATE	DESCRIPTION	SHOP
0	01-5-08	RELEASED FOR FABRICATION					
A	12-1-08	ISSUED FOR APPROVAL					

		STRUCTURAL STEEL FABRICATORS 5319 SHREVE AVE. - ST. LOUIS, MISSOURI 63115 - Phone: 314-389-0666	
REF. DMS.: E102	PROJECT: JEFFERSON BARRACKS	DRAWN BY: AJB	DATE: 11-26-08
MTL: A36 U.N.	LOCATION: ST. LOUIS, MO	CHK'D BY: JAM	DATE: 12-29-08
WELD: E70xxLH	CUSTOMER: K&S ASSOCIATES	SHEET NO: 153	CONTRACT NO: G706
BOLTS: 3/4" U.N.	ARCH/ENGR: ROSS & BARUZZINI	CONTENTS: SEQ 1 BEAM DETAILS	
EDGE DIST: 1 1/4" U.N.	CLEAN SPEC: SSPC-SP2	PAINT: PPGSH-232 GREY	
HOLE: 1 3/16" U.N.	DRY MIL THK: 1.5 MILS		